



*Supa***turf**

line marking systems

Easy Marker

The Easy Marker

This line marker is a superseded version of the mini line marker, offering all the attributes of the mini but being used a complete system with the use of Redispray liquid. Supaturf Redispray liquid eliminates the need to clean the machine after every use. Redispray is supplied as a 18lt amount.

Contents

Preparation for use	27
Line Marking	28
Battery charging	28
Maintenance	29
Transport and Storage	29
Warranty	29



Preparation for Use

1. Remove the machine from it's box and raise the handle bar, (swing the brace into position to secure the handle bar) and plug the lead at the bottom of the handle into the socket on the back of the machine.
2. The machine is now ready for operation as the battery is fully charged prior to despatch.
3. The width of the line can be adjusted to your requirements by simply raising, lowering or twisting the spray nozzle.
4. Lay bucket of Redispray on it's side and remove bung with the tool supplied, screw plastic tap into it's place (making sure that it is closed). Stand bucket upright and place onto machine with the tap outlet going into the hose at the back of the machine, tighten yellow winged hose clip.
5. Remove the black closed cap from the SMV, fit the yellow nozzle cap and nozzle to the SMV (be sure that the rubber washer is in place).
6. Loosen the screw cap lid on the top of the bucket and open the plastic tap at the back of the machine.
7. Flick the switch - wait until the colour appears solid. The machine is now ready to commence marking.



Line Marking

1. Walk at a reasonable pace when line marking.
2. Once the ground has been marked out, allow the line to dry – the longer, the whiter and brighter.
3. For circle marking, use the circle marker attachment (that is available as an optional extra) or simply lift the front or a back wheel to mark circle.
4. For a more definite edge to the line, use the marking discs (that are available as an optional extra).
5. Avoid airlocks by not running the pump dry.
6. At the end of the line marking there is no need to clean the machine itself, but the following steps must be taken to ensure that no problems arise. Firstly close the plastic tap at the back of the machine and retighten the screw cap on top of the bucket; next remove the nozzle cap and nozzle from the SMV and replace with the black closed cap.
7. Thoroughly clean the nozzle cap and nozzle. Leave to soak in water in a small container as provided.
8. It is essential at this stage to connect the machine for battery charging. This is done by simply plugging the charger in the back of the machine and into a standard 240 volt power outlet and leave it. (See battery charging).
Redisplay available in White, Black, Red and Blue.

Battery Charging

A charger has been included with your machine and should be used as often as possible during regular use. This will help the batteries last longer.

1. Plug the charger into a power point.
2. Attach the plug from charger into socket at back of machine. A red light indicates charging, a green light indicates that the battery is fully charged.
3. Recharge will automatically cut out when batteries are fully charged and cut back in when batteries lose voltage. When machine is not in use, the charger can be left on at all times.

The lights on the back of the machine indicate the amount of charge in the batteries.

Batteries are fully charged when:

1. All red and green lights are lit up when switch is activated.
2. The light to the left is on and green when connected to the charger and batteries are charged.

Re-Charging is required when both green lights are no longer showing and the orange light is becoming dull.

Maintenance

Little maintenance is required due to the high quality of the liquids and user friendly nature of the machine. Regular maintenance will ensure reliability and should include;

1. Always clean nozzle tip with toothbrush provided. It is advisable to have a few spare nozzle tips in case of damage. These are available from your local Supaturf Distributor. Remove the nozzle tip and rubber seal from spray management valve and store in clean water between markings.
2. Attach battery charger after each marking – See Battery Charging.
3. Wash down machine and dry with a cloth.

Transport & Storage

1. Disconnect battery charger and power lead from the rear of the machine.
2. Fold the handle forward.
3. Your line marker weighs 22kg when empty.
Observe safe OH & S procedures when lifting the machine.

Warranty

Your Easy Marker machine comes with a 12-month warranty. Please fill in your warranty card and return to Supaturf.

Easy Marker - Parts

Part No	Description	Code
1	Starlock Washer	S/W
2	Wheel	WHEEL
3	Winged Hose Clamp (Ref: Page.27)	EM/WHC
4	Braided Hose	HOSE
5	Braided Hose 1/2"	NA
6	Filter Complete	EM/FILTER
7	Mini Chassis	M/CH
8	Hand Knob - 6mm x 2	H/K
9	Nozzle Arm	N/A
10	Spray Management Valve	SMV
11	Clear Tubing	C/T
12	Hose Clip (Ref: Page.26)	H/C
13	Hose Clip x 2 (Not Shown)	H/C
27A	Battery Bracket	B/B

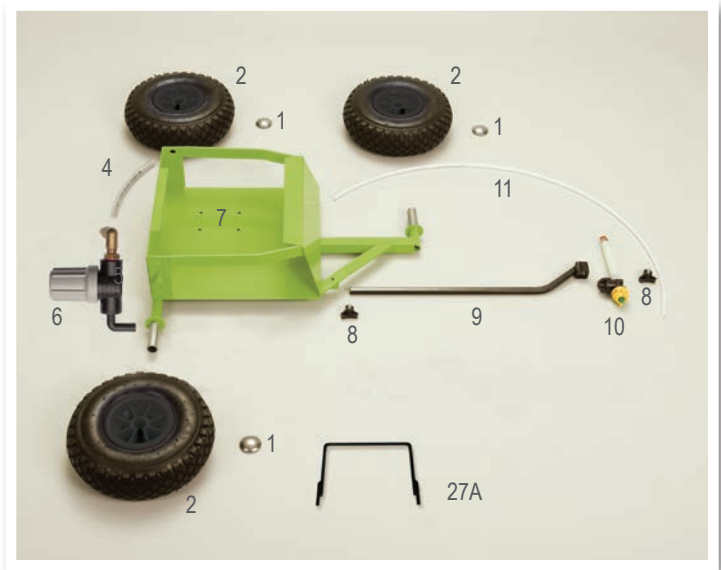

Easy Marker - Parts

Part No	Description	Code
14	Hand Knob - 12mm x 2	H/K/12
15	Bolt and Washer	M12x30/M12x3
16	Handle Bar	H/B
17	Top Cover	EM/TC
18	Spacer and Screw	SP24/M6x50
19	Handle Bar Grip	H/B/G
20	Tool Box	T/BOX
22	Handle Bar Brace	H/B/B
23	Top Screw	M6x40
24	Bottom Screw	M6x20
26	Rocker Switch	R/SW

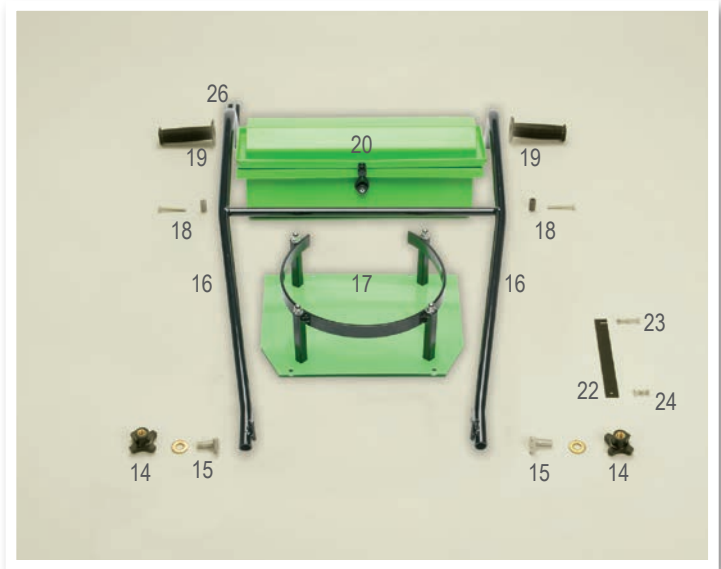

Easy Marker - Wiring

Part No	Description	Code
27	Battery	B/12
28	Pump	PUMP
28A	Pump & Fittings	PUMP /EM
28B	Tube Fitting	TF8/38
28C	Hose Tail	ADT/S
29	Control Box	C/BOX
30	Cable	CABLE/M
31	Rocker Switch	R/SE
32	Fuse - 5amp	FUSE
33	Wiring Loom	W/LOOM/M

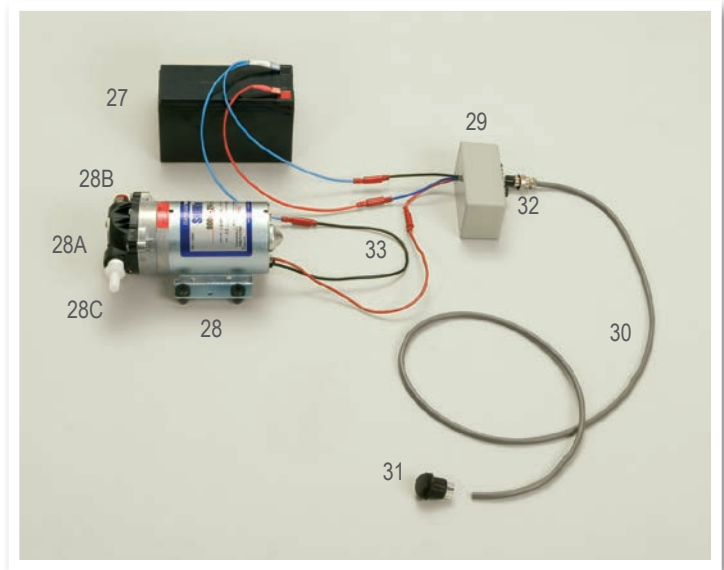

Easy Marker - Spray Management Valve

Part No	Description	Code
34	Spray Management Valve Complete	SMV
35	Tube Fitting	TF/8
36	Nozzle	N/SMV
37	Quick Valve	QV
38	Diaphragm Rubber	DR
39	Rubber Washer	QV/R
40	Nozzle Tip	N/TIP
41	Nozzle Cap	N/C
42	Black Closed Cap (Not Shown)	EM/CC

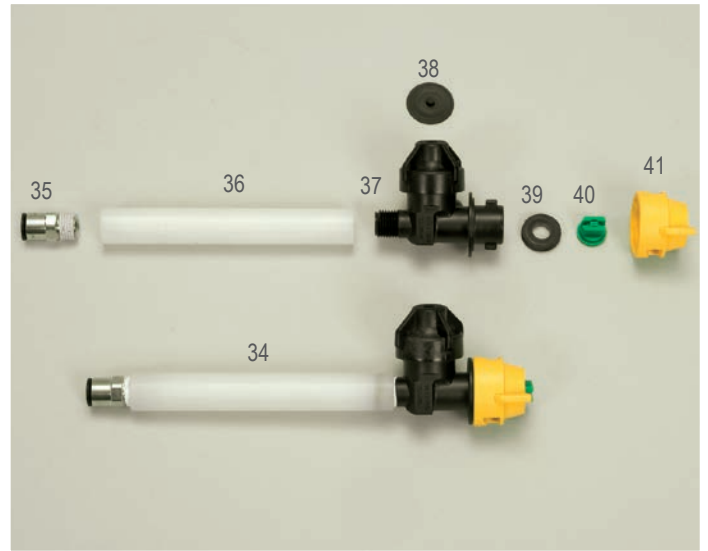

Easy Marker - Valve Train

Part No	Description	Code
43	Filter Complete	EM/FIL/COM
45	Elbow	EM/EL/1/4
46	Nipple - 1/4	1/4 NIP
47	Reducing Bush	R/B
48	Filter	FILTER
48A	Filter Seal	F/S
48B	Filter Screen	F/SC
48C	Filter Bowl (NA)	NA
49	Elbow	EM/EL
50	Hose Tail	EM/HT/1/4

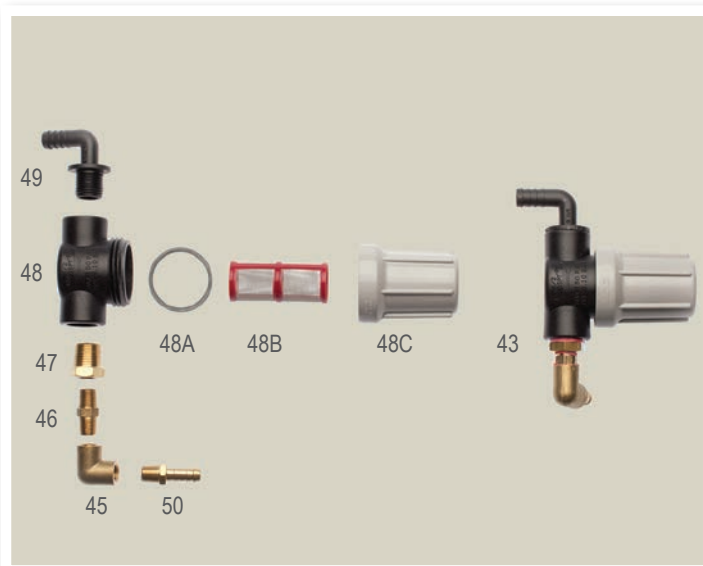

Easy Marker - Accessories

Part No	Description	Code
1	Battery Charger	CHAR
2	Spare Parts Bag	SPB
3	Nozzle Brush	N/B

*Spare Parts Bag includes

1x	Filter Seal	F/S
1x	Diaphragm Rubber	DR
2x	Rubber Washer	QV/R
2x	Nozzle Tip	N/TIP
1x	Fuse	FUSE

